



EMI/EMC COMPLIANCE

Conducted Emissions	EN55011/22 Class B, FCC Part 15, Subpart B, Class B with 6db margin
Radiated Emissions	EN55011/22 Class B; FCC Part 15, Subpart A, Class B
Common Mode Noise: High Frequency (100Khz -20Mhz)	<50mA pk-pk, 6mA rms CM current. See Application Note.
Common Mode Noise: Low Frequency (50-120 Hz)	<5Vrms. See Application Note.
Static Discharge Immunity	EN55024/IEC61000-4-2, Level 4, 8kV Contact Discharge, 15kV air discharge, Criteria A ¹
Radiated RF Immunity	EN55022/IEC61000-4-3, Level 3, 10V/m, Criteria A ¹
EFT/Burst Immunity	EN55024/IEC61000-4-4, Level 3, 4kV (PS Output), Criteria A; 2kV (signal outputs), Criteria B ¹
Line Surge Immunity	EN55024/IEC61000-4-5, Level 3, 1kV diff., 2kV Common-Mode, Criteria A ¹ Level 4, 2kV diff., 4kV Common-mode, Criteria B ¹
Conducted RF Immunity	EN55022/IEC61000-4-6, Level 4, 3V/m, 0.15 to 80MHz; and 10V/m in ISM and amateur radio bands between 0.15 and 80MHz, 80%AM at 1kHz, Criteria A ¹
Power Frequency Magnetic Field Immunity	EN55024/IEC61000-4-8, Level 4, 30A/m, Criteria A ¹
Voltage Dip Immunity	EN55024/IEC61000-4-11, Dips: 100%, 10ms; 30%, 500ms; 60%, 100ms; Interruptions: 100%, 5000mS; Performance Criteria A, A, B & B ¹
Line Harmonic Emissions	EN55024/IEC61000-3-2, Class A.
Flicker Test	EN55024/IEC61000-3-3

Notes:

Performance criteria are based on EN55024. According to the standards, performance criteria are defined as following:

1. Normal performance during and after the test
2. Temporary degradation, self-recoverable
3. Temporary degradation, operator intervention required to recover the operation
4. Permanent damage



MECHANICAL DRAWING

Open Frame Models:

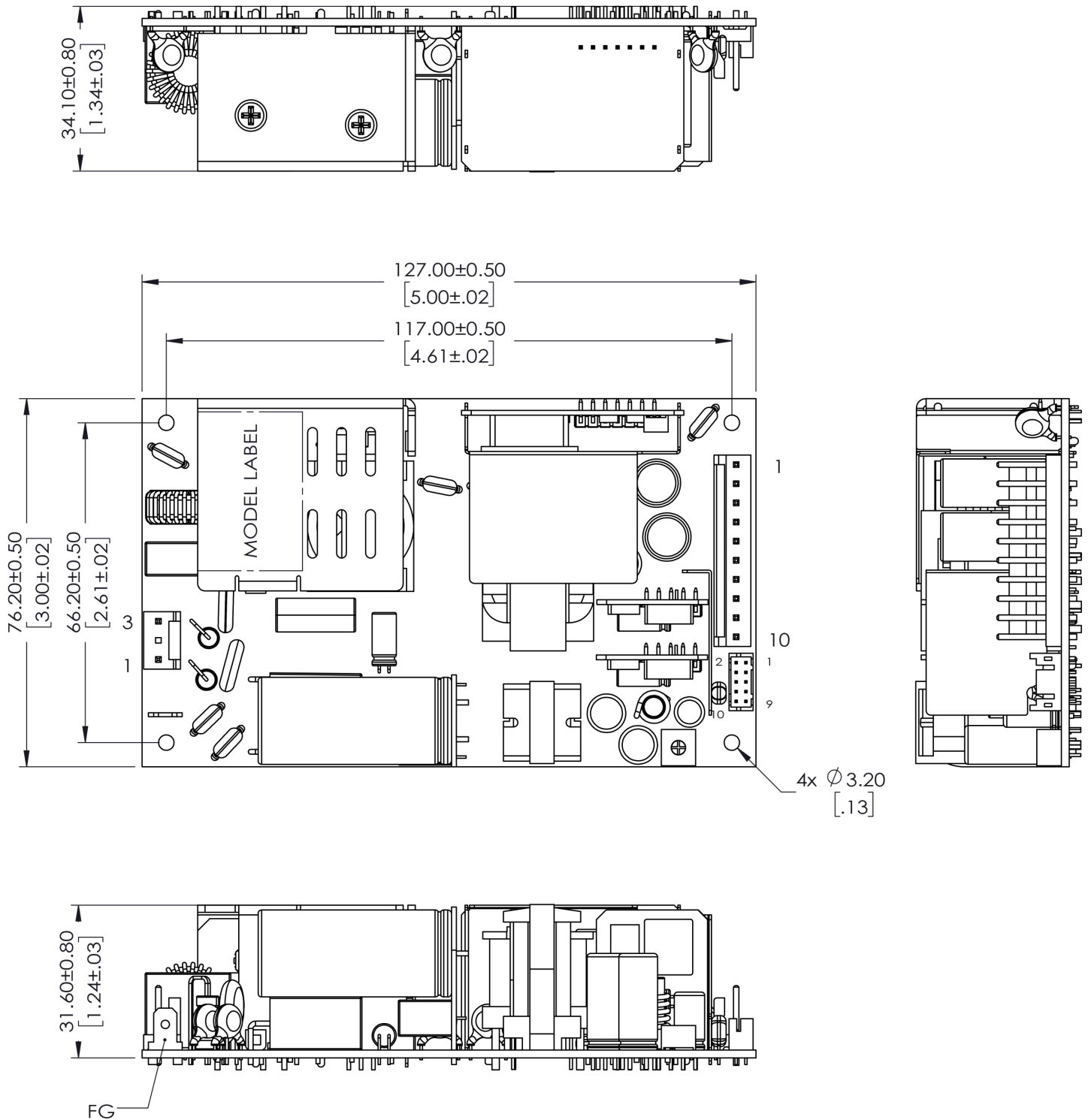

Notes:

1. All dimensions in inches (mm), tolerance is $\pm .02$ ".
2. Mounting holes should be grounded for EMI purpose
3. This power supply requires mounting on metal standoffs 0.20" (5 m) in height.



ISOLATION SPECIFICATIONS

Parameter	Conditions/Description	Min	Nom	Max	Units
Insulation Safety Rating	Input/Ground	1800	-	-	Vac
	Input/Output				
	Output/Ground				
Electric Strength Test Voltage	Input/Ground	4000	-	-	Vac
	Input/Output				
	Output/Ground				

LEAKAGE CURRENT

Parameter	Conditions/Description	Max
Earth Leakage Current	Normal Condition (NC)	290 μ A
	Single Fault Condition (SFC)	420 μ A
Touch Current	Normal Condition (NC)	90 μ A
	Single Fault Condition (SFC)	170 μ A

CHARACTERISTIC CURVES

Output vs. Temperature

Open Frame: 100W convection cooled and 130W continuous with 200 LFM airflow. Derate output power to 50% at 70C.

Covered Versions: Convection cooled output power is 75% of open frame ratings. Air-cooled output power is 80% of open frame ratings.

